

Profesjonell DeleService



ENGINE AND GEARBOX

VAS 6096 ASE 404 510 00 000 COOLING SYSTEM CHARGE UNIT

The cooling system charge unit VAS 6096 serves as a means of charging the cooling system quickly, effectively and independent of gravity. An adapter from the cooling system tester V.A.G 1274 is used for this purpose. Coolant cannot circulate in an incorrectly filled cooling system containing air. The result is thermal stressing of individual engine parts. This can be completely avoided using the cooling system charge unit. There is also an aid for checking the cooling system for leaks directly prior to charging. This way, charging a defective or damaged cooling system can be avoided at the outset.

Advantages:

- + charging cooling system without air bubbles
- + big saving in time as bleeding no longer necessary
- + avoidance of incorrect charging by means of leak test before charging
- + effective charging and ease of operation
- + simple use
- + quick to set-up due to quick acting coupling system
- + operates using air pressure, 6 to 12 bar
- + safe to use on all models on market. Connection to expansion tank via adapter from cooling system tester V.A.G 1274.
- + function and leak test of charge unit without need for additional equipment (self test)

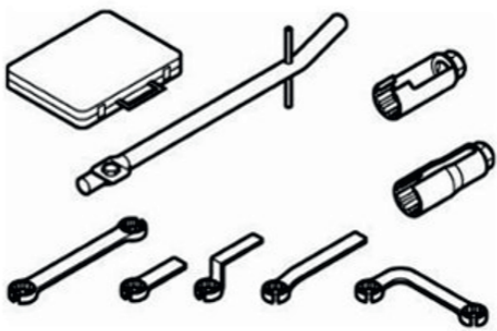

3337 V03 839 306 BN LAMBDA PROBE OPEN RING SPANNER

Lambda probe open ring spanner set 3337.
Installing Lambda probes.

| Varegruppe | Spesialverktøy 3300 - 3459 |
|----------------------------|----------------------------|
| Forpakningsmål (Ø × B × H) | 540×80×50 |
| Nettovekt (kg) | 2,711 |
| Garanti (måneder) | 24 |



T10395B V03 839 310 EF DIESEL ENGINE TOOL SET

Various Volkswagen and Audi models. Diesel engines with particulate filter. Removal and installation of senders and sensors on systems for purification of exhaust gasses.

Produsent: Bosch Automotive Service Solutions GmbH

| Varegruppe | Spesialverktøy T10001 - |
|----------------------------|-------------------------|
| Forpakningsmål (Ø × B × H) | 340×270×82 |
| Nettovekt (kg) | 2,073 |
| Garanti (måneder) | 24 |

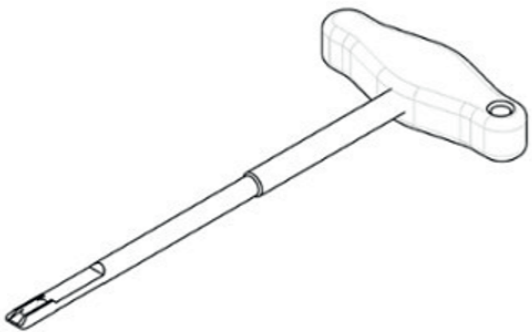

T10534 V03 839 124 PG ASSEMBLY TOOL

Golf 2013 →, Phaeton 2003 →
Assembly group: 7-speed dual clutch gearbox 0CW,
Automatic gearbox 01L 5-speed, all-wheel drive
Application: For setting selector lever push button in fitting position.

| Varegruppe | Spesialverktøy T10001 - |
|----------------------------|-------------------------|
| Forpakningsmål (Ø × B × H) | 190×100×22 |
| Nettovekt (kg) | 0,084 |
| Garanti (måneder) | 24 |



T10490 ASE 531 008 00 B00 HOSE CLAMP PLIERS

Accessory for coolant flushing and filling device VAS 531 007.
The pliers are required for clamping off various coolant circuits.
Clamping range: 12.5 mm to 19mm
Required items: 1 pack = 2 pieces, #-ASE 531 008 00 B00

| Varegruppe | Kuehlung |
|----------------------------|------------|
| Forpakningsmål (Ø × B × H) | 260×175×60 |
| Nettovekt (kg) | 0,139 |
| Garanti (måneder) | 24 |



VAS 6291A ASE 401 349 01 000 CHARGING DEVICE FOR AWD CLUTCH COUPLING

The adapter VAS 6291A is required in conjunction with the original 1 litre oil container to fill 4WD couplings.
The oil runs into the self-bleeding valve automatically.
Produsent: Autotestgeraete Leitenberger GmbH.

| Varegruppe | ATF-Befuelleinrichtung |
|----------------------------|------------------------|
| Forpakningsmål (Ø × B × H) | 400×75×220 |
| Nettovekt (kg) | 0,72 |
| Garanti (måneder) | 24 |



T10490 V03 839 037 JP CRANKSHAFT CLAMP

Crankshaft stop T10490
Audi A3 2013 →, Golf 2013 →
4-cyl. Common rail (1.6 and 2.0 l, 4V, turbocharger).

| Varegruppe | Spesialverktøy T10001 - |
|----------------------------|-------------------------|
| Forpakningsmål (Ø × B × H) | 80×90×60 |
| Nettovekt (kg) | 0,346 |
| Garanti (måneder) | 24 |

ENGINE AND GEARBOX



3359
V03 839 306 CG
LOCKING PIN
Diesel injection pump locking pin 3359. Locking fuel injection pump when removing and installing toothed belt.

| | |
|----------------------------|----------------------------|
| Varegruppe | Spesialverktøy 3300 - 3459 |
| Forpakningsmål (Ø × B × H) | 86×57×22 |
| Nettovekt (kg) | 0,026 |
| Garanti (måneder) | 24 |

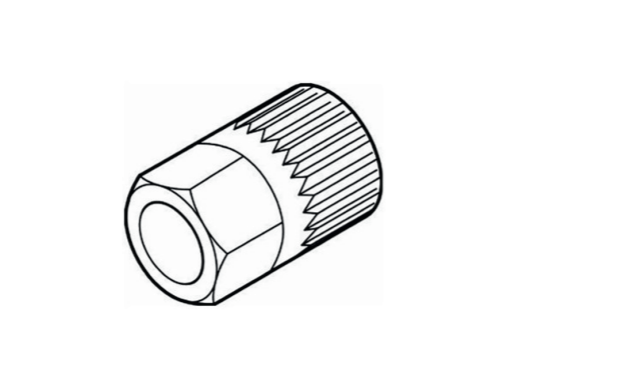

3400
V03 839 306 DB
ADAPTER
Removing and installing V-belt pulley with freewheel.

| | |
|----------------------------|----------------------------|
| Varegruppe | Spesialverktøy 3300 - 3459 |
| Forpakningsmål (Ø × B × H) | 58×58×21 |
| Nettovekt (kg) | 0,04 |
| Garanti (måneder) | 24 |

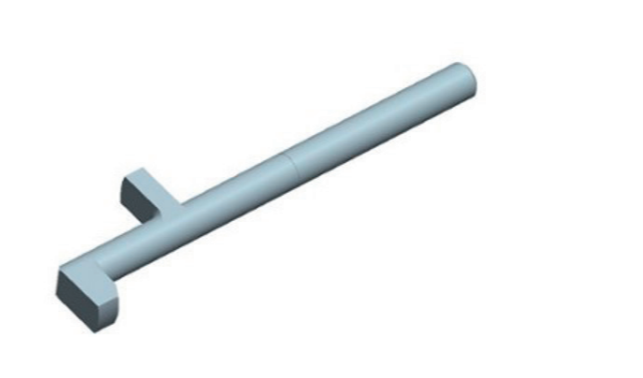

T10524
V03 839 124 NG
RETAINING BAR
Tiguan 2008 →, Transporter 2010 →
7-speed dual clutch gearbox 0BH and 0BT
Fitting dual clutch gearbox

| | |
|----------------------------|-------------------------|
| Varegruppe | Spesialverktøy T10001 - |
| Forpakningsmål (Ø × B × H) | 135×10×35 |
| Nettovekt (kg) | 0,095 |
| Garanti (måneder) | 24 |



T10526
V03 839 124 NT
THRUST PIECE
Thrust piece T10526, Tiguan 2008 →, Transporter 2010 →
7-speed dual clutch gearbox 0BH and 0BT
Fitting drive plate to outer plate carrier.

| | |
|----------------------------|-------------------------|
| Varegruppe | Spesialverktøy T10001 - |
| Forpakningsmål (Ø × B × H) | 100×58×55 |
| Nettovekt (kg) | 0,83 |
| Garanti (måneder) | 24 |



VW387
V03 839 140 A
UNIVERSAL DIAL GAUGE BRACKET
Universal dial gauge bracket VW 387. Checking valve guides, adjusting differential, adjusting forward clutch axial play
Skoda tool number: MP 3 - 447

| | |
|----------------------------|--------------------------------|
| Varegruppe | Spesialverktøy VW 119 - VW 801 |
| Forpakningsmål (Ø × B × H) | 175×80×45 |
| Nettovekt (kg) | 0,32 |
| Garanti (måneder) | 24 |



VAS 6079
ASE 469 720 00 000
DIAL INDICATOR
Dial gauge designed to meet DIN 878-A standards. Measuring range: 0-10 mm. Measuring pins made from non-rusting steel. Shaft diameter: 8 mm/h6. Scale in 0.01 mm. Housing diameter: 58 mm. Supplied with plastic case. Produsent: Wenzel GmbH.

| | |
|----------------------------|------------------|
| Varegruppe | Optische Geraete |
| Forpakningsmål (Ø × B × H) | 147×98×40 |
| Nettovekt (kg) | 0,27 |
| Garanti (måneder) | 24 |

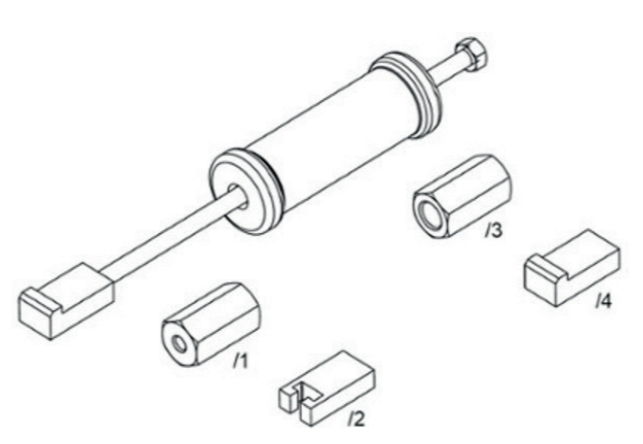

T10055
V03 839 124 BJ
PULLER - UNIT INJECTOR
Removing unit injector from cylinder head.

| | |
|----------------------------|-------------------------|
| Varegruppe | Spesialverktøy T10001 - |
| Forpakningsmål (Ø × B × H) | 218×58×50 |
| Nettovekt (kg) | 1,04 |
| Garanti (måneder) | 24 |

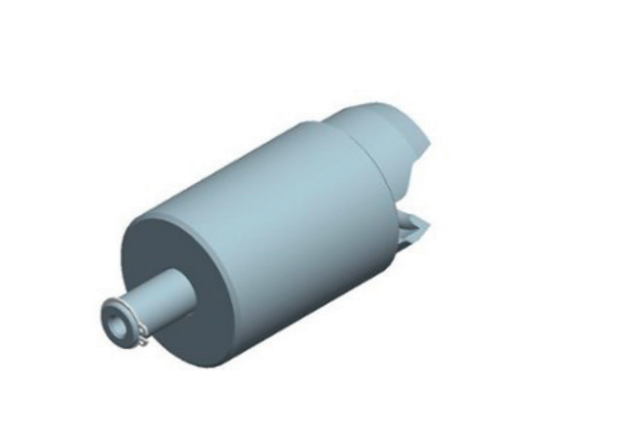

T10525
V03 839 124 NS
PULLER
Tiguan 2008 →, Transporter 2010 →
7-speed dual clutch gearbox 0BH and 0BT
Removing drive plate

| | |
|----------------------------|-------------------------|
| Varegruppe | Spesialverktøy T10001 - |
| Forpakningsmål (Ø × B × H) | 140×60×60 |
| Nettovekt (kg) | 0,954 |
| Garanti (måneder) | 24 |

ENGINE AND GEARBOX

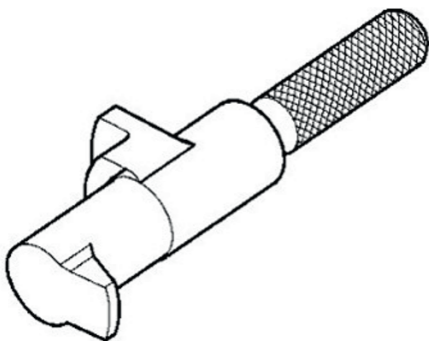

T10303
V03 839 124 LR
RETAINING BAR

Golf 2004 →, Touran 2004 →, Audi A3 2004 →, Audi TT 1999 →,
Direct shift gearbox 02E. For assembly of multiple clutch

| | |
|----------------------------|-----------------------|
| Varegruppe | Spesialverktøy T10001 |
| Forpakningsmål (Ø × B × H) | 95×58×15 |
| Nettovekt (kg) | 0,115 |
| Garanti (måneder) | 24 |

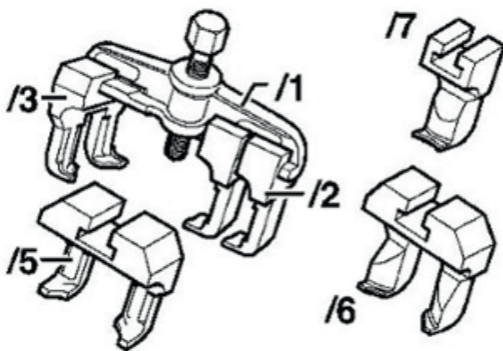

T40001
V03 839 141 AL
TWO-ARM PULLER

Two arm puller T40001
Removing camshaft sprockets

| | |
|----------------------------|------------------------|
| Varegruppe | Spesialverktøy T40001- |
| Forpakningsmål (Ø × B × H) | 140×70×42 |
| Nettovekt (kg) | 1,715 |
| Garanti (måneder) | 24 |

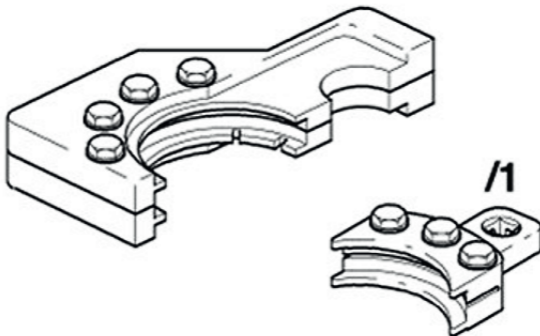

T10199
V03 839 124 GK
CLAMP

Touareg 2003 →, Phaeton 2003 →, Transporter 2004 →,
5 and 10-cyl. diesel engine. For removing and installing camshaft
drive gear and eliminating play in gear train.

| | |
|----------------------------|-------------------------|
| Varegruppe | Spesialverktøy T10001 - |
| Forpakningsmål (Ø × B × H) | 220×102×60 |
| Nettovekt (kg) | 4,917 |
| Garanti (måneder) | 24 |

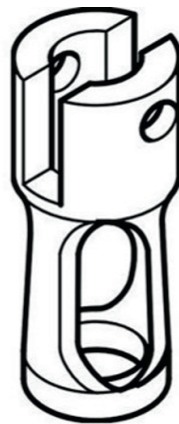

VW541/5
V03 839 140 GB
VALVE LEVER - PRESS TOOL

Press tool for VW 541 / 1 A and 2037 VW 541 /5.
Removing valve springs.

| | |
|----------------------------|--------------------------------|
| Varegruppe | Spesialverktøy VW 119 - VW 801 |
| Forpakningsmål (Ø × B × H) | 85×57×31 |
| Nettovekt (kg) | 0,164 |
| Garanti (måneder) | 24 |

3093
V03 839 300 EC
HOSE CLAMPS

Clamping off coolant hoses.
Hose clamps, up to 40 mm.

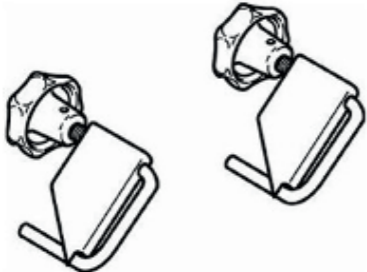

| | |
|----------------------------|----------------------------|
| Varegruppe | Spesialverktøy 2000 - 3199 |
| Forpakningsmål (Ø × B × H) | 110×120×50 |
| Nettovekt (kg) | 0,474 |
| Garanti (måneder) | 24 |

3094
V03 839 300 A
HOSE CLAMPS

Clamping off coolant hoses.
Hose clamps, up to 25 mm.

| | |
|----------------------------|----------------------------|
| Varegruppe | Spesialverktøy 2000 - 3199 |
| Forpakningsmål (Ø × B × H) | 85×75×40 |
| Nettovekt (kg) | 0,22 |
| Garanti (måneder) | 24 |

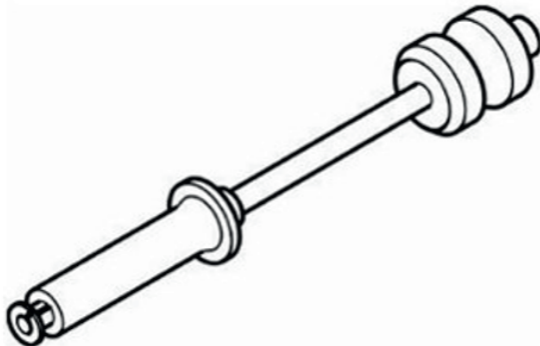

3047A
V03 839 300 CE
PULLER

Removing valve stem seals.
removing and installing valve spring retainers.

| | |
|----------------------------|----------------------------|
| Varegruppe | Spesialverktøy 2000 - 3199 |
| Forpakningsmål (Ø × B × H) | 350×51×51 |
| Nettovekt (kg) | 1,273 |
| Garanti (måneder) | 24 |

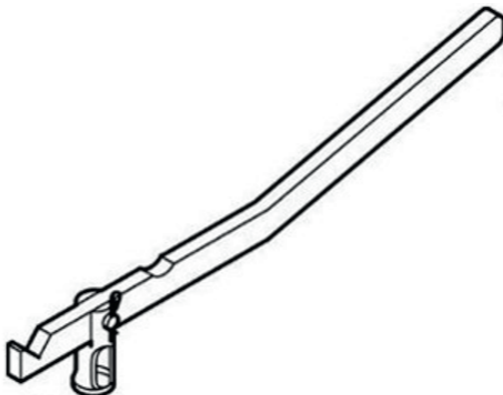

VW541/1A
V03 839 140 GA
VALVE LEVER

Removing valve springs.

| | |
|----------------------------|--------------------------------|
| Varegruppe | Spesialverktøy VW 119 - VW 801 |
| Forpakningsmål (Ø × B × H) | 415×90×30 |
| Nettovekt (kg) | 0,882 |
| Garanti (måneder) | 24 |

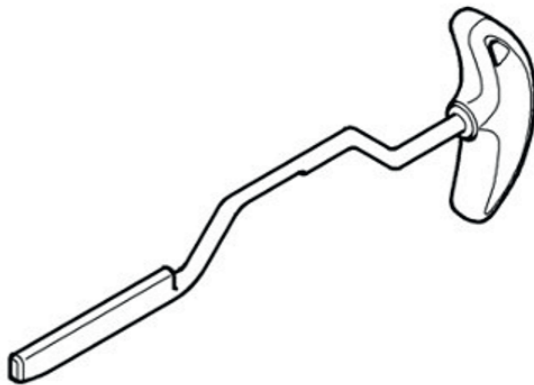

T10407
V03 839 037 BM
ASSEMBLY LEVER

Golf 2004 →, Golf 2009 →, Golf Plus 2005 →, Touran 2004 →,
Audi A3 2004 →, Eos 2006 →, Passat 2006 →, Passat CC 2009 →,
Scirocco 2009 →. 7-speed dual clutch gearbox 0AM.
To operate the engaging lever during dismantling and mounting of
the mechatronic unit.

| | |
|----------------------------|-------------------------|
| Varegruppe | Spesialverktøy T10001 - |
| Forpakningsmål (Ø × B × H) | 263×90×19 |
| Nettovekt (kg) | 0,121 |
| Garanti (måneder) | 24 |

CALIBRATION

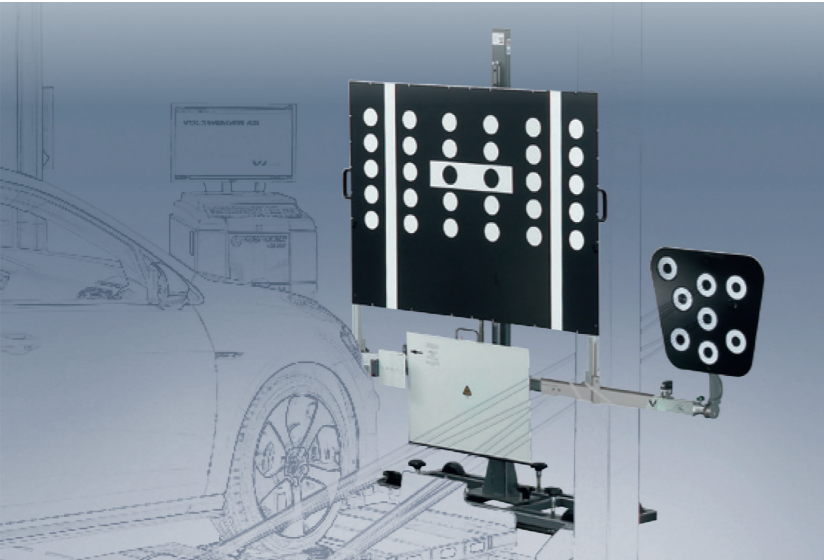

VAS 6430
ASE 423 210 00 000
SETTING DEVICE

The setting device VAS 6430 with the adapted calibration board VAS 6430/4 is aligned to the geometrical driving axis with the wheel alignment systems approved by VOLKSWAGEN AG. In the next step the sensors can be learnt

Items supplied

- + 1 base frame with A-frame and 3 adjustable feet to setup base frame
- + 1 carrier pillar with line unit and one man operating device
- + 1 setting bar with precision guide rail for mounting ACC/ADC laser box or ACC reflector mirror and camera calibration board
- + 1 ACC laser box, inc. acoustic signal VAS 6430/2
- + 1 Phaeton setting disc with screen print
- + 1 Passat setting disc with screen print and adapter
- + 1 ACC reflector mirror with laser unit and acoustic signal VAS 6430/3
- + 1 coarse setting mirror for AUDI ACC sensor
- + 1 calibration board for lane guard system, inc. frame and precision slats VAS 6430/4
- + 1 gap measuring unit with tape measure and pins (qty. 2)
- + 1 Mobile base frame VAS 6430/8
- + 1 set of assembly and operating instructions



VAS 721001
ASE 721 001 00 000
CALIBRATION SYSTEM

Used to calibrate the new generation of surround cameras. The driver assist surround camera system offers a 360° view of the area surrounding the vehicle through 4 cameras (front, rear and exterior mirrors). The system has to be calibrated if the cameras change their position, for example after the camera, the mounting component or the control unit is replaced.

The calibration process requires a relatively flat, cleared surface (normal workshop floor).

The setting device VAS 6430 serves to adjust the radar sensor from ACC systems and also to calibrate the image sensor from the lane guard system. The Adaptive Cruise Control (ACC) is an extension of the conventional cruise control system (CCS). The CCS regulates the speed of the vehicle to a setting entered by the driver.

The ACC system implements this convenience function in the same way, with the added feature of adapting the speed to that of the vehicle travelling directly ahead if it is moving slower. A radar head regulates the distance to the vehicle travelling ahead in conjunction with electronic control systems and by measuring the distance and relative speed. The lane guard system warns the driver by vibrating the steering wheel if the vehicle leaves its lane unintentionally.

VAS 6350A
ASE 423 200 01 000
CALIBRATION TOOL

Used for calibrating reversing camera. Basic equipment for calibrating surround camera and lane change assist. The product has been technically revised. The previous product can still be used. The application is described in the relevant workshop manual.

Items supplied:

- + 1 x calibration board
- Included in case:**
- + 1 x line laser VAS 6350/3A
- + 1 set of wheel center mountings VAS 6350/1A

comprising:

- + 2 x paddles
- + 2 x bodies
- + 6 x wheel bolt adapters VAS 6350/1-3A (AF 17, with magnets, adapter in red)
- + 6 x wheel bolt adapters VAS 6350/1-4A (AF 19, with magnets, adapter in blue)
- + 6 x spacers



VAS 6350/4
ASE 423 204 00 000
CALIBRATION UNIT

Accessory for calibration unit VAS 6350. The calibration unit is required for calibration of the lane change assist system. The repair process is described in the workshop manual.

Items supplied

- + 1 holding post VAS 6350/4-1
- + 1 post mounting, left VAS 6350/4-2
- + 1 post mounting, right VAS 6350/4-3

In case:

- + 1 Doppler simulator VAS 6350/4



VAS 6350/6
ASE 423 206 00 000
PERIPHERAL CAMERA CALIBRATION DEVICE

Used for calibrating reversing camera. Basic equipment for calibrating surround camera and lane change assist. The product has been technically revised. The previous product can still be used. The application is described in the relevant workshop manual.

Accessory for calibration device VAS 6350. The calibration device is required to calibrate the area scan camera. The repair process is described in the workshop manual.

Items supplied

- + 1 mounting post with left plate VAS 6350/6-1
- + 1 mounting post with right plate VAS 6350/6-2
- + 1 left post mount VAS 6350/6-3
- + 1 right post mount VAS 6350/6-4
- + 1 guide pin VAS 6350/6-5
- + 1 line scan laser mount VAS 6350/6-6
- + 1 case



DIAGNOSIS



VAS 6150E

ASE 995 206 74 037

PROFESSIONAL DIAGNOSIS UNIT

Technical data

- + Protection category IP52
- + CPU: Intel • Core™ i5-6300U vPro™
- + Memory: 8 GB DDR3
- + Storage medium: 250 GB SSD
- + Display: 14" HD TN 16 9, 1,366 x 768
- + Inputs / outputs: HDMI, 1 x USB 2.0, 3 x USB 3.0, 2 x rugged USB, SD/SDHC card reader, PKI reader
- + LAN: 10/100/1,000 MBit/s
- + Wireless LAN: Intel Dual Band AC-8260 802.11 a/b/g/n/ac
- + Bluetooth®: 4.2
- + OS: Windows 10 IoT Enterprise LTSB
- + Recovery partition for quickly restoring the factory settings when support is required
- + Docking station inputs/ outputs: 3 x USB 3.0, USB to LAN, HDMI, DisplayPort, parallel port, RS232
- + Global remote access authorisation



VAS 6154A

ASE 405 431 01 001

CAN-FD DIAGNOSTIC INTERFACE FOR ENGINEER

The diagnosis interface VAS 6154A with wireless networking technology supersedes diagnosis interface VAS 6154. It can be used with ODIS Service (Offboard Diagnostic Information System – Service), version 5.0.0 or higher, and with ODIS Engineering (Offboard Diagnostic Information System Engineering), version 9.0 or higher. It enables wireless data transmission from the interface in the vehicle to the diagnosis unit. On modern vehicles, diagnostic functions can only be carried out at full CAN-FD speed with this diagnostic interface. If a wireless connection is not possible/permissible, the USB module is used, which guarantees a reliable wired data transmission to the diagnosis unit.

Infrastructure mode In infrastructure mode, several networkcapable devices can be connected together (network subscribers). For a wireless network, a wireless access point is required. This access point forms the connection to wireless-enabled subscribers.



VAS 5055/4

ASE 405 258 00 000

COMPUTER ADAPTER FOR PERSONAL USE

The adapter VAS 5055/4 is required to convert remote diagnosis head VAS 5054A with Fischer connector (3m USB cable) or diagnosis interface VAS 5055 with Fischer connector to a standard USB connector.



DIAGNOSIS

VAS 1978B ASE 401 510 02 023 WIRING HARNESS REPAIR SET

The new wiring harness repair set allows optimum repair quality in the area of vehicle electrical systems. With the new pliers and release tools, repairs can be carried out on wiring connectors and damaged wires (wiring open circuit). To do this, complete repair wiring sets with connectors from wiring assortment set VAS 1978B already fitted are used and joined with the aid of 4 different types of crimp connectors with the wiring harness of the vehicle. A new set of crimping pliers with exchangeable heads and a hot air gun for heat shrinking the crimp connectors and also a handy gas-powered hot air blower provide a perfect electrical connection. Design and features Plastic case including hot air blower, carrier for assembly tools and trays for single wire seals, cable ties and repair wiring. Produsent: TKR Spezialwerkzeuge GmbH



Repair wires
Single wire seals
Cable ties
Electric cutter
4 types of crimp connectors (0.35mm²-6.0mm²)
1 roll of insulating tape, yellow
1 roll of insulating tape, black
1 set of repair instructions
Note: To replenish items, order from the Parts Division in Kassel.

In one part of the case is a tool carrier for mounting the crimping pliers, stripping pliers, release tools, assembly aids for single wire seals, insulation tape and thrust connectors. In the trays there are crimp connectors and cable ties In the other half of the case are the repair wires with industrially fitted contacts. Items supplied In plastic case:
Hot air blower 220 volts (110 volt as an option)
Hot air blower, gas-powered
Crimping pliers (basic tool) with 3 different heads
Stripping pliers
11 release tools with replacement blades
4 assembly aids for single wire seals

| | |
|----------------------------|----------------------|
| Varegruppe | Ledningsnett,diverse |
| Forpakningsmål (Ø x B x H) | 800×400×350 |
| Nettovekt (kg) | 16 |
| Garanti (måneder) | 24 |

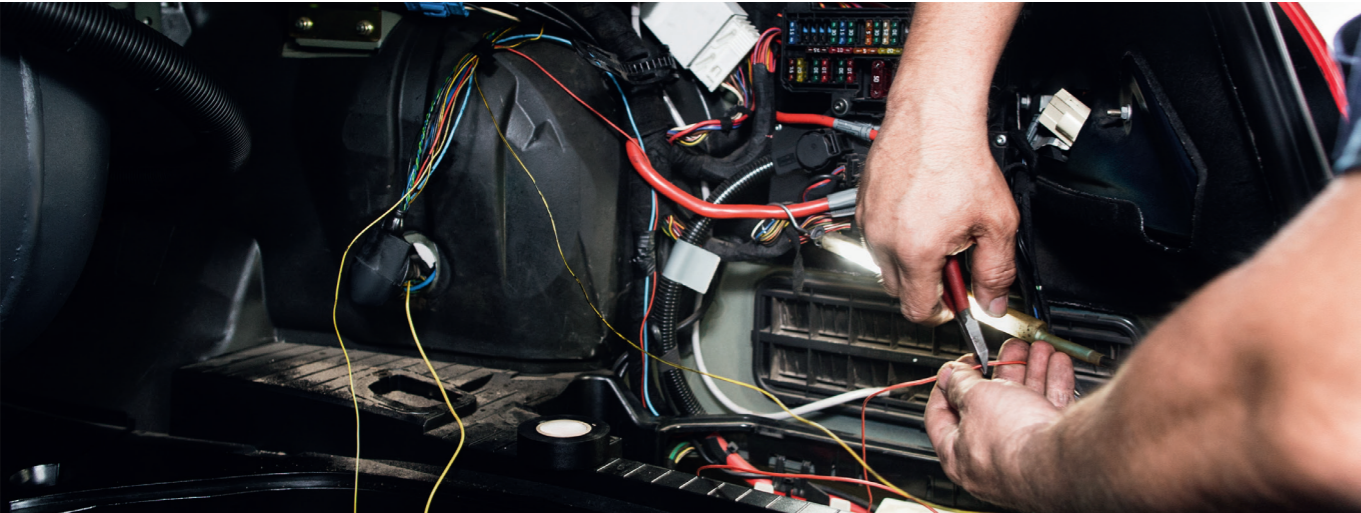

VAS 1978/35 ASE 401 578 00 000 RELEASE TOOL SET

The tool set serves as a means of releasing different connector housings on Group vehicles. The set comprises of 26 different tools with which, for example, round connector systems, flat contacts with one or two fasteners or even single wire seals can be released and/or fitted. More detailed instructions show with practical examples how the tools are used. Produsent: TKR Spezialwerkzeuge GmbH

Items supplied, 22 release tools, 4 fitting tools

| | |
|----------------------------|-------------------------|
| Varegruppe | Ledningsnett, opplåsing |
| Forpakningsmål (Ø x B x H) | 340×290×80 |
| Nettovekt (kg) | 1,5 |
| Garanti (måneder) | 24 |



VAS 1978/50 ASE 401 614 00 000 UPGRADE KIT

The upgrade kit VAS 1978/50 is required to bring the "old" wiring harness repair set VAS 1978 up to the new VAS 1978A standard. The upgrade kit comprises of all assembly and release tools, as well as new crimping pliers for 0.35mm²-6mm² crimps and a crimp adapter for JPT contacts. There are also new sticky labels included for the tools, a new set of operating instructions, 0.35mm² crimp connectors and a roll of black felt sticky tape.

Items supplied, 10 release tools, 4 assembly tools, Crimping pliers with 3 adapters, 1 pack 0.35mm² crimps, 1 roll of felt sticky tape Various sticky labels and a set of operating instructions VAS 1978A

| | |
|----------------------------|----------------------|
| Varegruppe | Ledningsnett,diverse |
| Forpakningsmål (Ø x B x H) | 446×324×32 |
| Nettovekt (kg) | 1,87 |
| Garanti (måneder) | 24 |

BODY AND CLIMATE



VAS 6614/1 VAS 895 003/007/011/013/027 VAS 6379 CUTTING TOOL

Tool for cutting out the holes for parking sensors. This tool is necessary for cutting out the holes in the bumper. Ivelable in different sizes. In between 18,2 - 40,2 mm.



VAS 6614C ASE 412 176 03 000 ASSEMBLY TOOL FOR PDC HOLDER

For replacing defective PDC holders on bumpers. For retroactive punching of PDC sensor holes. Tool for cutting out the holes for parking sensors.

| | |
|----------------------------|--------------------------------------|
| Varegruppe | Tueren/Anbauteile/Zentralverriegelun |
| Forpakningsmål (Ø x B x H) | 280×180×130 |
| Nettovekt (kg) | 2,1 |
| Garanti (måneder) | 24 |

BODY AND CLIMATE

VAS 861 001A

ASE 861 001 00 000

WINDSCREEN REMOVAL SET

- + include an angle drive and a flexible bit extension.
- + include an angle drive and a flexible bit extension.
- + Cutting tool for vehicle windows.
- + Time saved due to easy and quick handling.
- + Application by one person possible.
- + No damage to the paintwork and interior due to soft and flexible cutting cord.
- + Can be used with a commercially-available cordless screwdriver with at least 14.4V.
- + The set does not include a cordless screwdriver.

Design and features

- + Separating device is made of aluminium.
- + The movable parts have gunmetal bearings.
- + The cord is wound by a cordless screwdriver.

Items supplied

1 angle drive, 1 flexible bit extension, 1 cutting device, 1 awl, 1 trim wedge, 1 cord hook, 1 bit extension, 1 cutter, 2 cutting guard, 2 rolls of cutting cord, Set of operating instructions



VAS 861001/1

ASE 861 002 00 A00

CUTTING CORD

- + Extremely strong cord for cutting out vehicle windows
- + No damage to the body and paintwork

Design and features

- + Multi-braided cord

Technical data

- + Very strong PE cord
- + Length: 65 m
- + Thickness: approx. 0.95mm
- + Pull strength: 110daN



VAS 6872

ASE 412 196 00 000

THERMAL CLIP BONDER KIT

- + Serves to repair plastic parts on inside and outside of vehicles
- + Battery-powered tool (rechargeable)
- + Hand set VAS 6872/1
- + Adapter set VAS 6872/7 (short adapter, long adapter, 45°, 90° & short/long spacer bracket)
- + Charging station
- + Plug socket adapter, can be used around the world
- + Charging cable
- + Side cutters
- + Box of 5 assorted clips (M, S, V, W, U-clips)
- + Operating instructions in various languages



VARIOUS TOOLS

VAS 6845

ASE 485 432 00 000



Special plastic tools for damage-free removal of covers, door panels, strips, decorative trim, seals, clips, adhesive residue, etc. Sturdy plastic with varying degrees of hardness from white (soft plastic) to dark blue (very hard plastic).

T10039

V038 390 37 0S



Used when removing door trim. Used when dismantling door panel

VAS 6427

ASE 436 054 00 000



With these pliers the interior grab handles can be removed easily and without trouble.

T10057

V03 839 037 EA

RADIO RELEASE TOOL

Removing radios and radio navigation systems, removing reading lamp with interior monitoring



| | |
|----------------------------|-------------------------|
| Varegruppe | Spesialverktøy T10001 - |
| Forpakkingsmål (Ø x B x H) | 95x58x14 |
| Nettovekt (kg) | 0,025 |
| Garanti (måneder) | 24 |

T10051A

V038 393 10 LJ



Counter-hold tool T10051A
Tool used for counter-holding during removal or installation of camshaft pulley; 4-cyl. TDI CR, 2.0 l 4 V engine; Audi A4 2016→

T10558A / T10558

V038 393 10 MC



Releasing the retaining clips when removing the sun visor. The optimized shape of the special tool T10558A near the gripping surfaces makes it easier to release the retaining clips when removing the sun visors and is technically necessary for work involving them.

VARIOUS TOOLS

T40207
V038 391 11 BR



To remove analogue clock and doorhandel

VAS 6190/2
ASE 423 063 00 000



The setting tool VAS 6190/2 is required for adjusting the radar head of the Adaptive Cruise Control (ACC) system.

T10389
V038 390 37 RJ



Used for removal and installation of the lock cylinder housing on doors with no lock cylinder.

VAG 1634B
ASE 451 455 02 000



Upholstery clip pliers. For fitting aluminium clips, e.g. on seat padding and covers

N 015 261 2
CLIPS

Seat attachment clip



T10518A
V038 393 10 FL



The release tool serves to remove the roof grab handle of the Tiguan 2016 → without causing damage. The tool can also be used on the Golf 2013 → and Golf estate 2014 →

T10369
V03 839 124 CE

PULLER

Audi and Volkswagen models. For removing wiper arms on front wiper system with integrated pedestrian safety.

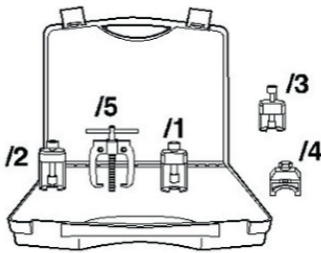

| | |
|----------------------------|-------------------------|
| Varegruppe | Spesialverktøy T10001 - |
| Forpakkingsmål (Ø x B x H) | 350x280x100 |
| 350x280x100 | 24 |
| Nettovekt (kg) | 1,018 |
| Garanti (måneder) | 24 |

THREE NEW DEVICES WHICH MAKES WORK IN THE WORKSHOP EASIER AND FASTER

Cleaning, filling, venting and testing are jobs being performed every day in a workshop. We have practical workshop equipment in our range, which makes the work easier and faster. On this page we present three new devices.

1

VAS 294 011A
ASE 294 011 70 000

THE CLEANER

The Cleaner is used to remove carbon build-up from inlet valves and inlet channels easily and thoroughly. Carbon build-up is removed by means of a special granulate mixture blown into the inlet channel via compressed air. The used granulate is removed during the spreading process by means of an industrial vacuum system. It is efficient and practical as it requires minimal deconstruction of the motor which means a faster and less expensive repair for the customer. It's an environmentally friendly process applying renewable natural resources as cleaning medium. The application is described in the relevant repair manual. Since no chemical agents are used which can damage the seals, it is also gentil on the engine. Compared to the previous version it is more stable, and the handle is easier to use. VAS 294 011A has been technically revised and extended by the scope of delivery VAS 294 011/10. O-ring VAS 294 011/9 has also been added.



The cleaner
VAS 294 011A

2

VAS 522 001
ASE 522 001 00 000

PRESSURE-LOSS TESTER

The Pressure-Loss Tester is used to verify the seal of individual cylinders of spark-ignition and diesel engines. Testing cylinders for pressure loss is a supplementary procedure to running a cylinder compression test. If a cylinder's compression pressure has been found to be conspicuously low, the exact location of the leak can be identified by means of pressure-loss testing, which is done by connecting the Pressure-Loss Tester to the workshop's compressed air supply. Only a few parts (spark plug, glow plug or injector) need to be removed to use the testing device. It helps keep the workshop's capital expenditure low: The testing device is namely employed by means of adapters already supplied to service dealers with the V.A.G 1763 Compression Tester Kit.



Pressure-loss tester
VAS 522 001

3

VAS 761 003
ASE 761 003 00 000

BREAK FILLING AND VENTING DEVICE

Modern braking systems can quickly and easily filled and vented with filling and venting devices for brakes VAS 761 003 which can be moved / steered. It has a new, patented one double-piston pump that generates a steady thrust current, which is proven to lead to higher compressive stress. This makes it possible to flush out even the smallest gas and dust particles safely from the brake system so that the system is fully vented. In addition it compensates for the extra pressure drop which regulatory elements, such as brake assistants, lead to in the braking system.

The new filling and venting device for brakes give good results and save time as the new pumping technology results in it taking less time to change brake fluid.



Break filling and venting device
VAS 761 003

CAR SUSPENSION



VW267A
V03 839 140 BA
REMOVING TOOL
Ball joint removal tool VW 267 A
Pressing together safety device when removing steering lock, pressing swivel joint out of wheel bearing housing

| | |
|----------------------------|--------------------------------|
| Varegruppe | Spesialverktøy VW 119 - VW 801 |
| Forpakningsmål (Ø × B × H) | 210×100×99 |
| Nettovekt (kg) | 2,551 |
| Garanti (måneder) | 24 |

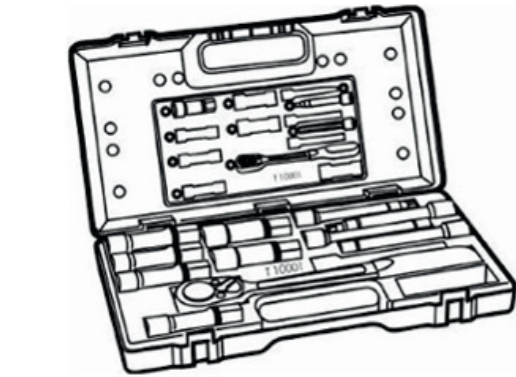

T10001
V03 839 037 BE
SHOCK ABSORBER SET
Repairing shock absorbers.

| | |
|----------------------------|-----------------------|
| Varegruppe | Spesialverktøy T10001 |
| Forpakningsmål (Ø × B × H) | 340×270×70 |
| Nettovekt (kg) | 2,875 |
| Garanti (måneder) | 24 |

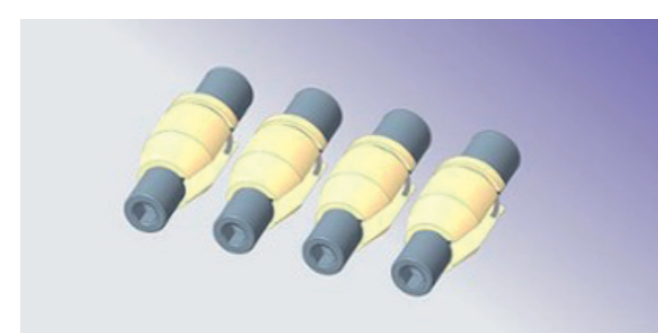

T50079
V03 839 900 FE
FASTENING DEVICE
With the aid of the locating device, the assembly carrier can be refitted to its original position after repair, without having to carry out a wheel alignment; T7 2021→.
Produsent: Bosch Automotive Service Solutions GmbH

| | |
|----------------------------|-------------------------|
| Varegruppe | Spesialverktøy T50001 - |
| Forpakningsmål (Ø × B × H) | 65×60×15 |
| Nettovekt (kg) | 0,342 |
| Garanti (måneder) | 24 |



T40139 A
V03 839 141 CE
TEST PIN
Checking thickness of brake pads and depth of tyre tread.

| | |
|----------------------------|-----------------------|
| Varegruppe | Spesialverktøy T40001 |
| Forpakningsmål (Ø × B × H) | 180×58×16 |
| Nettovekt (kg) | 0,046 |
| Garanti (måneder) | 24 |



T10145
V03 839 037 DH
PISTON RESETTING APPLIANCE
Piston resetting appliance T10145. Volkswagen- and Audi-models. For resetting brake piston in conjunction with T10146.

| | |
|----------------------------|-------------------------|
| Varegruppe | Spesialverktøy T10001 - |
| Forpakningsmål (Ø × B × H) | 295×125×50 |
| Nettovekt (kg) | 1,664 |
| Garanti (måneder) | 24 |



VAG1682A
ASE 451 472 01 000
CLAMPING PLIERS
Tool for fitting ear-type clamps used on sealing gaiters of outer drive shaft joints. The application is described in the workshop manual. Items supplied, Clamp tensioning tool, insert AF8, 3/8" drive , ASE 451 472 01 000. Produsent: Hazet-Werk

| | |
|----------------------------|------------|
| Varegruppe | Zangen |
| Forpakningsmål (Ø × B × H) | 255×110×30 |
| Nettovekt (kg) | 0,87 |
| Garanti (måneder) | 24 |



T10146
V03 839 037 RD
ASSEMBLY TOOL
With the aid of the locating device, the assembly carrier can be refitted to its original position after repair, without having to carry out a wheel alignment; T7 2021→

| | |
|----------------------------|-------------------------|
| Varegruppe | Spesialverktøy T10001 - |
| Forpakningsmål (Ø × B × H) | 175×90×70 |
| Nettovekt (kg) | 0,407 |
| Garanti (måneder) | 24 |



T10096
V03 839 124 AD
LOCATING PINS
Locking subframe.

| | |
|----------------------------|-------------------------|
| Varegruppe | Spesialverktøy T10001 - |
| Forpakningsmål (Ø × B × H) | 60×60×15 |
| Nettovekt (kg) | 0,175 |
| Garanti (måneder) | 24 |

CAR SUSPENSION

T10187 V03 839 037 EC BALL JOINT PULLER

Running gear. For pressing off upper and lower suspension links and track rod ball joints

| | |
|----------------------------|-------------------------|
| Varegruppe | Spesialverktøy T10001 - |
| Forpakningsmål (Ø × B × H) | 112×72×60 |
| Nettovekt (kg) | 1,304 |
| Garanti (måneder) | 24 |

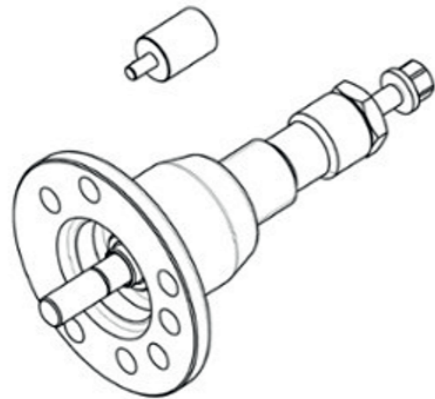
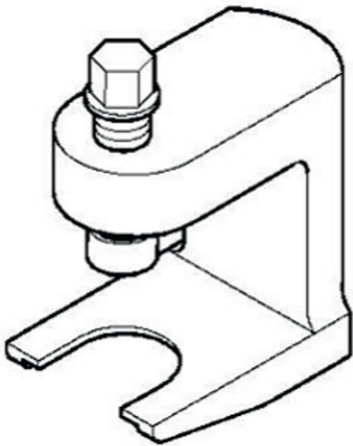

T10520A V03 839 310 GG EJECTOR

For removing drive shafts, T10520A replaces the basic unit T10103 and 3283A, the cover T10520/1 can be used with the hydraulic cylinder from 3283A. Produsent: Bosch Automotive Service Solutions GmbH.

| | |
|----------------------------|-------------------------|
| Varegruppe | Spesialverktøy T10001 - |
| Forpakningsmål (Ø × B × H) | 250×180×100 |
| Nettovekt (kg) | 4,04 |
| Garanti (måneder) | 24 |



VAS 6178 ASE 423 041 00 000 HYDRAULIC CYLINDER

The alloy, hollow plunger-type press is designed to take a maximum pressure of 20t and is suitable for a wide range of applications. The primary function is for removal and installation of hydraulic and standard bonded rubber bushes on rear axles of VW/AUDI passenger vehicles. Produsent: Longus GmbH.

Items supplied
1 hydraulic cylinder in plastic case
ASE 423 041 00 000

| | |
|----------------------------|-----------------------|
| Varegruppe | Achsen/Achsvermessung |
| Forpakningsmål (Ø × B × H) | 310×160×110 |
| Nettovekt (kg) | 6,09 |
| Garanti (måneder) | 24 |



T10313 V03 839 124 MB ADAPTER MASTER SET FOR TAMPER PROOF

Adapter set for tamper-proof wheel bolts T10313
Passat 2006 →, Running gear, For removal and installation of tamper-proof wheel bolts.

| | |
|----------------------------|-------------------------|
| Varegruppe | Spesialverktøy T10001 - |
| Forpakningsmål (Ø × B × H) | 270×230×85 |
| Nettovekt (kg) | 3,036 |
| Garanti (måneder) | 24 |



T10190 / T10101A V03 839 124 HT / V03 839 124 E AD. SET FOR TAMPER-PROOF WHEEL BOLTS

Touareg 2003 →, Running gear. Loosening and tightening tamper-proof wheel bolts. Adapter set for tamper-proof wheel bolts. Installing tamper-proof wheel bolts.

| | |
|----------------------------|-------------------------|
| Varegruppe | Spesialverktøy T10001 - |
| Forpakningsmål (Ø × B × H) | 270×225×83 |
| Nettovekt (kg) | 2,51 |
| Garanti (måneder) | 24 |



T40073 V03 839 141 AG AD. SET FOR TAMPER-PROOF WHEEL BOLTS

Audi A6 2005 →, Loosening and tightening tamper-proof wheel bolts.

| | |
|----------------------------|-------------------------|
| Varegruppe | Spesialverktøy T40001 - |
| Forpakningsmål (Ø × B × H) | 280×230×85 |
| Nettovekt (kg) | 3,034 |
| Garanti (måneder) | 24 |

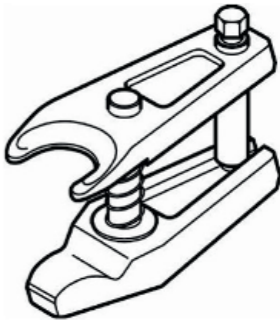

T50002 V038 399 000E BALL JOINT PULLER

Pressing ball joint off wishbone.

| | |
|----------------------------|-------------------------|
| Varegruppe | Spesialverktøy T50001 - |
| Forpakningsmål (Ø × B × H) | 180×170×65 |
| Nettovekt (kg) | 3,11 |
| Garanti (måneder) | 24 |

CAR SUSPENSION

T40004
V03 839 141 AH
AD. SET FOR TAMPER-PROOF WHEEL BOLTS
Loosening and tightening tamper-proof wheel bolts

| | |
|----------------------------|-------------------------|
| Varegruppe | Spesialverktøy T40001 - |
| Forpakkingsmål (Ø x B x H) | 30x22x22 |
| Nettovekt (kg) | 0,508 |
| Garanti (måneder) | 24 |

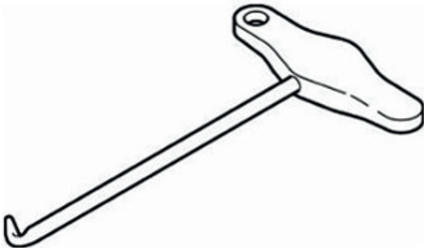

3438
V03 839 037 BH
HOOK
Removing and installing handbrake return spring.

| | |
|----------------------------|----------------------------|
| Varegruppe | Spesialverktøy 3300 - 3459 |
| Forpakkingsmål (Ø x B x H) | 180x110x25 |
| Nettovekt (kg) | 0,08 |
| Garanti (måneder) | 24 |

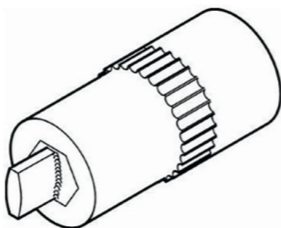

3424
V03 839 306 FJ
SPREADER
Separating suspension strut from wheel bearing housing.

| | |
|----------------------------|----------------------------|
| Varegruppe | Spesialverktøy 3300 - 3459 |
| Forpakkingsmål (Ø x B x H) | 58x58x25 |
| Nettovekt (kg) | 0,07 |
| Garanti (måneder) | 24 |



EASIER WORK IN THE WORKSHOPS: useful aids from the range



The right tools should not be underestimated - and can really make the working day easier in the workshop. An example is the tool kit for brake pistons or the wheel cleaner from the Volkswagen Workshop Equipment range. Here you can read more about these useful aids.

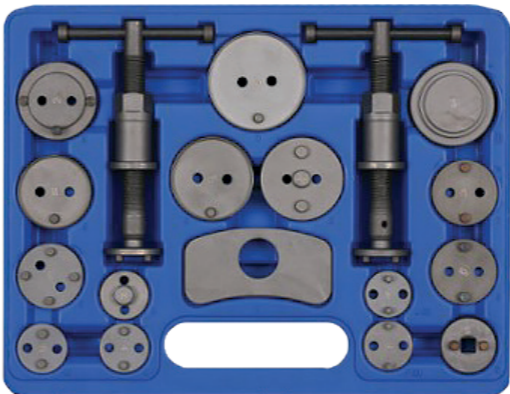

VAS 761 001
ASE 761 001 00 000
RESETTING BRAKE CALIPER PISTONS ON DISC BRAKES.

Volkswagen has the right tools so you can easily put brake pistons back on the disc brakes. The 18-part tool set for brake pistons, VAS 761 001, contains a right and a left spindle, Retaining plate and various adapters. It can therefore be used on a number of models from different manufacturers, both inside and outside the Volkswagen Group. In addition to this the flexibility the tool set of brake pistons also convinces with a special function: The adapters hold the spindles with a magnetic mount which prevents them from moving.



VAS 294 009
ASE 294 009 00 000
WHEEL HUB CLEANER

Professional tool for fast removal of rust and aluminum corrosion on the surface of wheel hubs, rims, brake drums, brake discs etc. The surface is rendered absolutely clean and rust-free in a matter of seconds. It leaves only a low dust generation and there are no deposits and no flying sparks. It saves time-intensive cleaning with a wire brush and allows for an easier day at the workshop. The aluminum bell has a steel core and 1/2" square drive for power driver. Other washers, such as Velcro fasteners, are available as spare parts. If a power drill/battery-powered drill is used, adapter VAS 294 009/3 is required

Spare parts / accessories for Wheel Hub Cleaner VAS 294 009
There are several spare parts and accessories for Wheel Hub Cleaner VAS 294 009

Cleaning discs
VAS 294 009/1 / ASE 294 010 00 400

Replacement part for wheel hub cleaner VAS 294 009.
Plastic disc with bonded Velcro receiver comes in sets of 3.



Velcro fixings
VAS 294 009/2 / ASE 294 010 00 800

To ensure that the cleaning discs VAS 294 009/1 stay firmly attached to the wheel hub cleaner VAS 294 009, it may be necessary to replace the self-adhesive Velcro fixing VAS 294 009/2 on the wheel hub cleaner VAS 294 009. The Velcro fixings come in sets of 2.



Adapter
VAS 294 009/3 / ASE 294 010 00 C00

Accessory for wheel hub cleaner VAS 294 009. This adapter is required to use the wheel hub cleaner VAS 294 009 with a power drill/rechargeable drill instead of a 1/2" power driver. Steel adapter with mounting for power drill chuck.

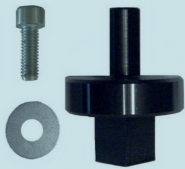

PDS[®]

Profesjonell DeleService

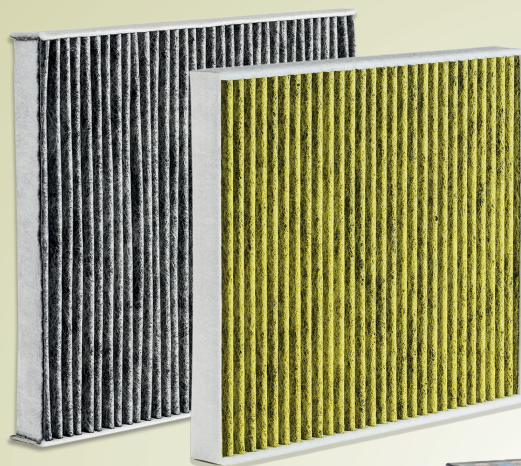

SEAT

ŠKODA

Nyttkjøretøy